



WEM 4000 Series Feed Conference

August 15 - 17, 2017

This completely new conference format provides focused training on the WEM Feed System covering five unique topics (tracks). Each of the five tracks represent a selection of one-day training sessions that include hands on labs, multi-media presentations, open technical discussions and current job-aid handouts. Students will interact closely with a team of instructors in their choice of the full-day session, enabling them to dig deep into those areas of their highest interest.

Each student has the opportunity to customize their conference experience by selecting any TWO of the five tracks that most closely match their learning interest. Each full day track is comprised of 30 minute to two-hour sessions, separated by breaks and a lunch each day. As each track is repeated the second day of the conference, students are given an opportunity to attend two full tracks of training topics while optimizing the student to teacher ratio.

An additional ½ day on Thursday is included in the cost of this conference. It provides students the opportunity of attending additional WEM Question & Answer sessions and / or presentations conducted by key WEM partners who will be presenting targeted training on their components. This time may also be used to schedule a special session with a WEM associate.

Due to the popularity of several of the training tracks, seating may be limited in some sessions. Registration will be on a first come first served basis so we suggest you register early to insure your selections for a quality learning experience. ***Hotel registration information and forms are included at the end of this document, followed by conference assigned classroom locations.***

This 2 ½ day conference will be held at the Sheraton Milwaukee - Brookfield Hotel in Brookfield WI starting Tuesday August 15, 2017. ***See hotel location map and room reservation details near the end of this document.***

A color-coded map of the conference facility will be provided upon arrival to help students navigate locations of events, lunch, break-out labs and content sessions.

Feed Conference Track Outlines

Troubleshooting
Inventory Management
Production / Operation
Calibration
Systems Interface / Information Technology

Track Outline

Troubleshooting

WEM 4000 Feed Control System

Purpose

Reduce your downtime! Pick up troubleshooting tips, techniques and best practices from the pros! Our hands on lab will present solutions for reducing hardware and electrical issues! It is geared towards **plant staff responsible for installing, maintaining and servicing** the WEM Feed Control.

A **Troubleshooting Lab Manual** will be handed out and followed during the lab session/presentation.

Overview / Introduction:

✓ **Attention Wisconsin Electrical Professionals:** The *Wisconsin Department of Safety & Professional Services (DSPS)* has approved this course (*ID 18862*) and has assigned registered attendees 8 hours of continuing education credit toward the following credential types:

- **Industrial Journeyman Electrician License**
- **Journeyman Electrician License**
- **Master Electrician License**
- **Registered Electrician Registration**

This lab will present the layout of the WEM Feed Control components, what they control, how they communicate and contribute to the success of your production. Real time presentations will be made utilizing Allen Bradley SLC and Compact PLCs, Discrete and Analog I/O, Variable Frequency Drives, Rice Lake scale meters, and Wonderware.

An operational feed mill control panel will be utilized to enable hands on troubleshooting lab work, right in the classroom!

Individual Sessions

Electrical Troubleshooting, covering:

- Component and device wiring.
- Reading schematics, wiring diagrams, and wire numbering schemes.
- Discrete and analog devices such as: circuit breakers, relays, thermocouples, potentiometers
- How to identify and resolve common circuit faults.

PC Troubleshooting, covering:

- Basic PC functions, hardware identification and troubleshooting.
- Preventative maintenance, corrective actions and best practices.

PLC Troubleshooting, covering:

- PLC hardware, I/O cards, Device Net, Ethernet.
- The function and purpose of WEM system components.
- How field devices are wired and communicate with the WEM Feed Control.
- Determining the operational states of field devices.
- Identifying how WEM system components are represented on schematics and wiring diagrams.

System Resources, covering:

- WEM support tools and resources available to customers.
- Technical WEM customer support Internet connection features and options.
- Using GoToAssist for real-time, on-line WEM technical support.

Track Outline

Inventory Management

WEM 4000 Feed Control System

Purpose

Looking for the most effective way to manage material inventory at your mill? What's been received? What's in your warehouse? What just left the mill as a finished product? How to process a returned order? This session will guide you through inventory management tools available to answer those questions. It has been designed to cover when and how materials are labeled and tracked in the Feed Control system, the maintenance of that data, plus the production and management reporting of material inventories.

A WEM handout provided to the attendees will be used in the presentations

Overview / Introduction:

WEM Feed applications having the greatest impact on material inventory will be discussed, as well as typical plant situations that may be used as a basis for best practices discussions.

A WEM Control system will be running in demo mode for hands on access in the classroom.

Individual Sessions

Veterinary Feed Directive (VFD), covering:

- How it will apply to your operation

Lot Code Introduction, covering:

- Standards and limitations.
- Received / Raw / Customer Lots vs System Lots.
- Lot Code Tree.

Lot Code Use & Maintenance, covering:

- Returned Orders
- Recalled Lots

New WEM Programs, covering:

- Hand held devices & new features
- WEM-Script / WEM Feed Track / Track & Trace 2 (TT-2) / WEM Alarm

Medicated Interlock, covering:

- Medicated Interlock interaction with existing / new formulas.
- Adding new materials / new formulas to the WEM System.
- Wildcard entries.

Lot Code Troubleshooting, covering:

- Retrieving lost Lot Codes

Track Outline
Production / Operation
WEM 4000 Feed Control System

Purpose

Are you interested in proven operational guidelines your entire operations staff can use to insure smooth production runs? This presentation will cover system operation with an emphasis on best practices, being proactive to typical production issues and how to effectively manage them.

Overview / Introduction,

The session will include interacting with the WEM Control system, such as: recognizing and responding to system and operator communications, also starting, stopping and recovery from unexpected conditions.

A WEM Control system will be running in demo mode for students to work with in the classroom.

Individual Sessions

Grinding, covering:

- Manual / automatic control of multiple grinding operations.
- Preparation of hammer-mill trending charts.

Batching, covering:

- Handling of Batching Orders, interaction with WEMSpeak.
- What is Collect? Batcom? Core?
- Batching order transactions.
- Pending / active formulas.
- Clearing "locked" Orders and resuming production.

Pelleting, covering:

- Interaction with TPS4000.
- Smart Bin mill controls and settings.
- Mill configuration processes.
- Textured Feed, Crumbling / Flaking

Data Manager, covering:

- The importance of this tool and its interaction with the plant and the WEM Control system.
- The role Data Manager plays in data entry and data validation.
- Accessing system parameters, data definitions and system reporting access.
- Preparing and making data available for other WEM Control applications.

**Track Outline
Calibration
WEM 4000 Feed Control System**

Purpose

Looking for the details on setting Bin Settle time? Maximum Freefall? Perhaps help optimizing Feeder Speed is needed. How does the "net weighing" concept work? Collect the answers to these and other issues directly from WEM technicians and **save production time by resolving issues right now!**

Overview / Introduction,

Discussions could include parameter settings for Bins, Liquids, Mixers and Scales. Additionally, the session has been formatted to cover analysis and deviations, manual operations and system reporting.

A **WEM Feed Reporting / Ticketing** reference document will be provided to the attendees.

A WEM Control system will be running in demo mode for students to work with in the classroom.

Individual Sessions

Calibration, covering:

- Basic calibration needs, development of calibration factors.
- Identify various calibration processes.
- Importance of system parameters and the accuracy of their settings.

WEM System Reporting, covering:

- The role Data Manager plays in system reporting.
- Tools used to catalog, manage and prepare report products.
- Standard vs Modified / Custom report formatting.
- How to select / prepare retrieval and sort parameters.
- Identify reporting and export options.

Key Performance Indicators (KPI), covering:

- Setting long term measurement / progress management goals.
- Review the management information the KPI feature provides.
- Standard template charts structures.
- Definition of Data Grouping, Data Selection methods and procedures.



Track Outline

Information Technology / System Interface

WEM 4000 Feed Control System

Purpose

Get answers to questions typically asked by **Information Technology / System Management** staff! This session has been designed to cover the WEM Control technical requirements, general IT topics plus Technology Interconnect information, Networking, Firewalls and how they pertain to the WEM system.

A WEM handout provided to the attendees will be used in the presentations.

Overview / Introduction,

Let us help take the mystery out of the management and control of production data transferred between your Front Office automated system and the WEM Control System.

Individual Sessions

WEMSpeak, covering:

- Interface configuration and basic operation between WEMSpeak and Front Office systems.
- Transfer template formatting specifications, and where used.
- Communication pathway to and from the WEM Control system employed by WEMSpeak.

Mapping to Data, covering:

- How to communicate with the WEM Feed system remotely (home, office or portable device).
- Remote communication requirements and connection "how to".

Network / Virtual Machine (VM), covering:

- Purpose of multiple network cards.
- Network topics including Domain, IP Addressing plus Virus scanning topics.
- System security

Autoback, covering:

- Purpose / features / functions of the Automatic Backup vs Manual Backup applications.

Emergency Computer Swap, covering:

- Repurposing a PC to replace a critical failed PC.
- SQL Backup and Restore.

Redundancy / RAID, covering:

- What is WEM Redundancy? What is RAID? What is it used for?

To Register: Fax, Mail or Email the 2 page form below to:

Regina Poledica, at WEM Automation LLC, P. O. Box 510767, New Berlin, WI 53151-0767
 Email: Rpoledica@wemautomation.com Phone: 262-782-2340 Fax: 262-782-2653.

For Each Student:

- Each of the FIVE one-day courses is repeated the second day.
- Choose ONE all-day course for Tuesday,
- Choose another (DIFFERENT) all-day course for Wednesday,
- Reserve Thursday morning for special sessions (to be announced).

Circle your selection for each day, for each student. For more than 8 students provide a second form.

		A - Tuesday	B - Wednesday	C - Thursday
Student		Select <u>one</u> all-day course per student	Select <u>one</u> all-day course per student	½ day, topics to be announced
1	Name:	Troubleshooting	Troubleshooting	Special Topics
		Inventory	Inventory	
		Production	Production	
	email:	Calibration	Calibration	
		Info. Technology	Info. Technology	
2	Name:	Troubleshooting	Troubleshooting	Special Topics
		Inventory	Inventory	
		Production	Production	
	email:	Calibration	Calibration	
		Info. Technology	Info. Technology	
3	Name:	Troubleshooting	Troubleshooting	Special Topics
		Inventory	Inventory	
		Production	Production	
	email:	Calibration	Calibration	
		Info. Technology	Info. Technology	
4	Name:	Troubleshooting	Troubleshooting	Special Topics
		Inventory	Inventory	
		Production	Production	
	email:	Calibration	Calibration	
		Info. Technology	Info. Technology	
5	Name:	Troubleshooting	Troubleshooting	Special Topics
		Inventory	Inventory	
		Production	Production	
	email:	Calibration	Calibration	
		Info. Technology	Info. Technology	
6	Name:	Troubleshooting	Troubleshooting	Special Topics
		Inventory	Inventory	
		Production	Production	
	email:	Calibration	Calibration	
		Info. Technology	Info. Technology	
7	Name:	Troubleshooting	Troubleshooting	Special Topics
		Inventory	Inventory	
		Production	Production	
	email:	Calibration	Calibration	
		Info. Technology	Info. Technology	
8	Name:	Troubleshooting	Troubleshooting	Special Topics
		Inventory	Inventory	
		Production	Production	
	email:	Calibration	Calibration	
		Info. Technology	Info. Technology	

Thursday will be a 1/2 day of one hour sessions on topics of high interest (to be announced). To tailor this time to your preferences, we are soliciting your suggestions. These will be announced prior to the class, communicated directly to the student's email addresses provided in the registration form. Please feel free to suggest topics for these sessions which would be useful to you as part of the training process.

Suggested Additional Topics, Comments, or Questions:

PRE-REGISTER AND SELECT NUMBER OF SEATS IN ABOVE COURSES

Company _____ Contact _____
Address _____ Phone _____
City, State, Zip _____ Fax No. _____

Feed Conference Tuition

An early registration tuition fee of \$1,295.00 per student is available through Friday, June 16, 2017. Starting Monday, June 19, 2017, the registration tuition fee will be \$1,495.00 per student. This tuition fee covers all conference sessions, session hand outs and mid-day lunches. Sessions start at 8:00 AM and will run to approximately 5:00 PM daily.

Make checks payable to WEM Automation LLC, or confirm via your company purchase order. Attendees are responsible for their own transportation to and from the training conference, as well as lodging and meal costs, other than the WEM sponsored lunches.

A fee of **\$150.00** will apply if a registered student cancellation is received after Friday, July 14, 2017. If WEM is notified that an alternate student will fill the cancelled registration, the cancellation fee will be waived.

Payment Options:

Bill me using P.O. # _____

Name: _____

Visa/Master card # _____ Exp. date: _____

Security Code: _____

I am paying by check. (Make check payable to WEM Automation LLC)

Total Number of Students Registered: _____



WEM 4000 Series Feed Conference

August 15 - 17, 2017

Hotel and room reservation details:

WEM Automation, LLC has set aside a block of rooms for this Feed Conference containing 1 king bed, at a rate of \$109 + taxes, per night. Costs may vary for other room configurations that you may request at time of registration. Make your reservations by contacting the hotel at your convenience.

Sheraton Milwaukee - Brookfield Hotel, 375 S Moorland Rd., Brookfield WI 53005

www.sheratonmilwaukeebrookfield.com

Phone: 262-364-1100, Reservations: 888-627-8235

The Sheraton Milwaukee - Brookfield Hotel is located west of Milwaukee, approximately 30 minutes from the Milwaukee airport. The facility is immediately north of Interstate 94 / Exit 301 north on South Moorland Rd. (See map here). It is in the business district, across the parking lot from Brookfield Square Mall, close to numerous restaurants and retail outlets

A partial list of hotel features includes: free airport transportation, a complimentary breakfast, an indoor pool, a seasonal outdoor pool, fitness center, refrigerators and flat-screen televisions and complimentary wireless Internet access...

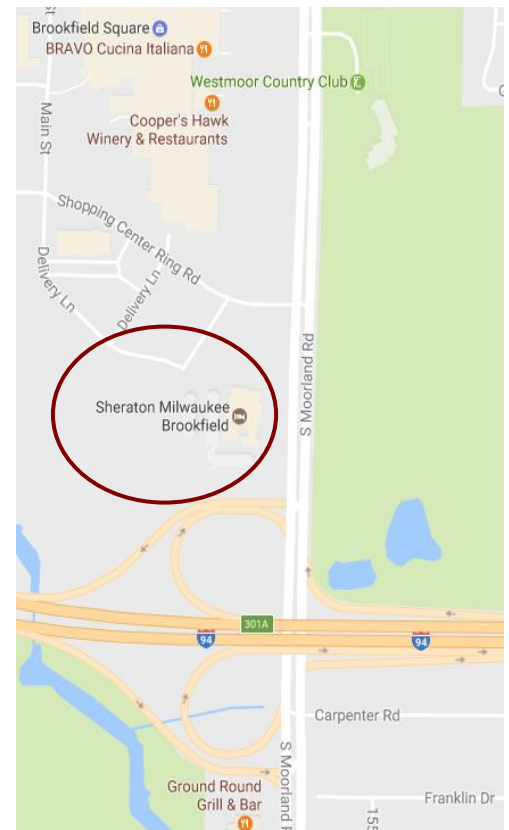

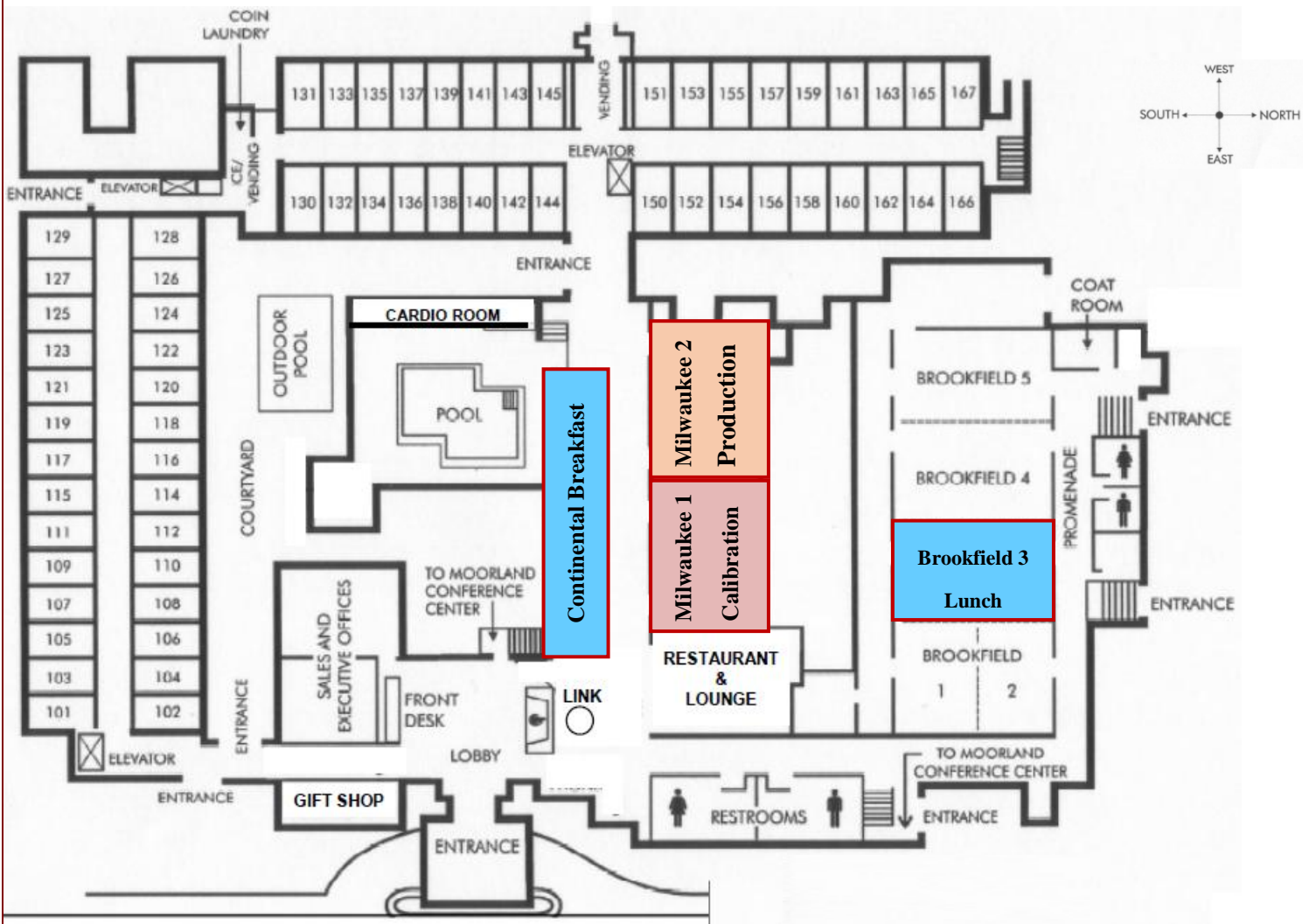

LOWER LEVEL

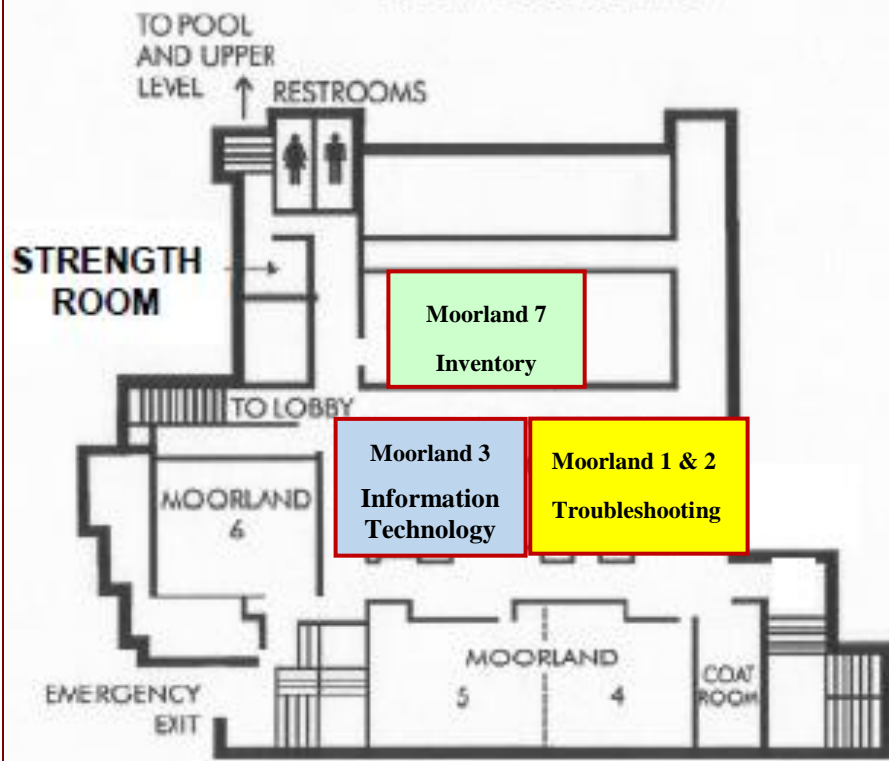

Troubleshooting
Inventory Management
Production / Operation
Calibration
Systems Interface / Information Technology